

# Thermal transfer analysis of tubes with extended surface with fractal design

Análisis de transferencia térmica de tubos con superficies extendidas con diseño fractal

Análise de transferência térmica de tubos com superfícies estendidas com desenho fractal

Fecha de recepción: 3 de septiembre de 2017  
Fecha de aprobación: 30 de noviembre de 2017

Luis Eduardo Llano-Sánchez\*  
Darío Manuel Domínguez-Cajeli\*\*  
Luis Carlos Ruiz-Cárdenas\*\*\*

## Abstract

Heat exchangers are formed by tubes with extended surfaces that improve the transfer of heat between two media (*e.g.*, a solid and a liquid in motion). This paper presents the design of an extended surface tube with fractal geometry, corresponding to the Koch snowflake and the Cesaro curve. For the design, we used the CAD computational tool, and afterwards we performed the CAE finite element analysis and verified the thermal behavior of the designed tube. We were able to reduce the heat transfer time and increase the heat flow in the system in the following manner: for smooth tube, 250 W/m<sup>2</sup>; for Koch surface, 500 W/m<sup>2</sup>; for six fins, 1450 W/m<sup>2</sup>; and for Cesaro curve, 3600 W/m<sup>2</sup>. These results demonstrate the limits of the design and the advantages of its implementation in machinery such as condensers, heat exchangers, and boilers.

**Keywords:** boilers; Cesaro curve; finite elements; fractal design; heat transfer; Koch Snowflake; tubes with extended surface.

## Resumen

Los intercambiadores de calor están conformados por tubos con superficies extendidas, con el propósito de mejorar la transferencia de calor entre dos medios, que pueden ser un sólido y un líquido en movimiento. En el presente trabajo se expone el diseño que se llevó a cabo de un tubo de superficie extendida con geometría fractal, correspondiente al copo de Koch y la curva de Cesaro, con la herramienta computacional CAD, para luego realizar el análisis por elementos finitos CAE y verificar el comportamiento térmico del tubo diseñado. Se logró obtener como resultado reducir el tiempo de transferencia de calor y aumentar el flujo de calor en el sistema del modo siguiente: para tubo liso, 250 W/m<sup>2</sup>; para superficie de Koch, 500 W/m<sup>2</sup>; para seis aletas, 1450 W/m<sup>2</sup>, y, finalmente, para curva de Cesaro, 3600 W/m<sup>2</sup>. Todo ello, permitió evidenciar los límites del diseño y las ventajas que pueden llegar a tener respecto a su implementación en maquinarias como condensadores, intercambiadores de calor y calderas.

\* Universidad Militar Nueva Granada (Bogotá-Distrito Capital, Colombia). luis.llano@unimilitar.edu.co. ORCID: 0000-0001-7372-0437.

\*\* M. Sc. Universidad Militar Nueva Granada (Bogotá D.C., Colombia). dario.dominguez@unimilitar.edu.co.

\*\*\* Universidad Militar Nueva Granada (Bogotá D.C., Colombia). u3900195@unimilitar.edu.co.

**Palabras clave:** calderas; copo de Koch; curva de Cesaro; diseño fractal; elementos finitos; transferencia de calor; tubos de superficie extendida.

## Resumo

Os permutadores de calor estão conformados por tubos com superfícies estendidas, com o propósito de melhorar a transferência de calor entre dois meios, que podem ser um sólido e um líquido em movimento. No presente trabalho expõe-se o desenho que se realizou de um tubo de superfície estendida com geometria fractal, correspondente ao floco de Koch e a curva de Cesaro, com a ferramenta computacional CAD, para logo realizar a análise por elementos finitos CAE e verificar o comportamento térmico do tubo desenhado. Logrou-se obter como resultado reduzir o tempo de transferência de calor e aumentar o fluxo de calor no sistema da seguinte maneira: para tubo liso, 250 W/m<sup>2</sup>; para superfície de Koch, 500 W/m<sup>2</sup>; para seis aletas, 1450 W/m<sup>2</sup>, e, finalmente, para curva de Cesaro, 3600 W/m<sup>2</sup>. Tudo isto, permitiu evidenciar os limites do desenho e as vantagens que podem chegar a ter em relação a sua implementação em maquinarias como condensadores, permutadores de calor e caldeiras.

**Palavras chave:** caldeiras; floco de Koch; curva de Cesaro; desenho fractal; elementos finitos; transferência de calor; tubos de superfície estendida.

Cómo citar este artículo:

L. E. Llano-Sánchez, D. M. Domínguez-Cajeli, and L. C. Ruiz-Cárdenas, "Thermal transfer analysis of tubes with extended surface with fractal design," *Rev. Fac. Ing.*, vol. 27 (47), pp. 29-35, Jan. 2018.

## I. INTRODUCTION

The design of tubes with extended surface has been important due to the necessity of cooling electronic devices and/or engines through free convection [1, 2, 3], and handling oxidation reactions based on heat transfer in hybrid vehicles [4]. The research in this area has allowed avoiding heating problems, and the subsequent potential failures or mechanical problems [1]. This research is based on the analysis of finite elements, to study the thermal-mechanical behavior, through simulations of continue thermal variations and energy absorption [5, 6]. Likewise, artificial neural networks have been used to observe the times in convection processes in plain but small diameter tubes [7].

The analysis of finite elements requires knowing the materials used to construct the tubes, such as graphite and carbon used for nanotubes of different diameters [1, 8], brass [6] and its alloys [9], reinforced plastic fiber [5], which has good thermal properties and mechanical strength, and iron alloys with chrome [10]. Therefore, the relationships between materials and design of mechanical parts have improved the performance in industrial mechanisms [4, 11, 12]; for example, new structural designs, such as thin origami tubes have been created to improve energy absorption [6] and heat transfer (*e.g.*, Vipertext tubes) [13], and to optimize extended surfaces that reduce costs and improve heat flow [9]. Another variation in the design of extended surfaces is found on how the toothed fins are handled, that is, the height, thickness, and number of fins vary to evaluate the heat transfer flow between the environment and the fast reactors [10]; additionally, internal fins can be used to perform high-fast cooling [14, 15] in the same way ultrasonic vibrations are used [16].

The graphical concept of fractal geometry has been introduced to the design of physical structure of mechanical parts to take advantage, in the industrial process, of the structures observed in nature [17]; for example, to evaluate supports and their structural strength [18, 19], and to interpret porous microstructures to improve the thermal conductivity efficiency of electrical circuits [20].

In this paper, we begin by describing the methodology used to design the tubes with fractal extended surfaces, then explain the Koch snowflake and Cesaro curve as

the fractal structures that were taken into account for the design, and then detail the flow analysis with finite elements. After obtaining a clear relation between the extended surfaces of a tube and its heat flow variation, we show the results of subjecting the tube to different internal and external temperatures. Finally, we analyze the results and present the conclusions obtained from the heat transfer analysis.

## II. METHODOLOGY

In order to design and analyze the tube with fractal extended geometry, first, we compared the fractal geometries similar to the longitudinal surfaces (Fig. 1). These types of tubes are commonly used in applications such as air coolers, dry coolers, evaporators, and condensers that transfer energy from a main liquid or refrigerant medium to the air [21]. The longitudinal surfaces are fins elaborated in thin aluminum plates, considered good conductors because they increase the heat transfer by increasing the main tube surface.

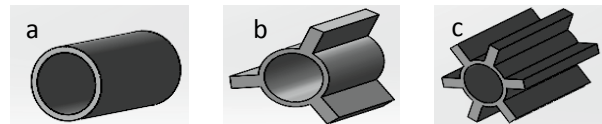

**FIG. 1.** Tube surfaces: a) Main smooth surface tube; b) extended surface tube with three longitudinal fins; c) extended surface tube with six longitudinal fins.

The heat transfer analysis for this kind of tubes corresponds to observing the thermal interaction between the fluid inside the tube and the external medium surrounding the extended surface. First, equation (1) calculates the thermal difference ( $\Theta$ ) between the fluid surrounding the fins ( $T_c$ ) and the specific point temperature over the fin ( $t$ ).

$$\Theta = T_c - t \quad (1)$$

Then, equation (2) takes into account the variation of the temperature along the height of the fin  $\left(\frac{d\Theta}{dl}\right)$ .

$$\frac{d\Theta}{dl} = -\frac{dt}{dl} \quad (2)$$

Equation (3) estimates the heat ( $Q$ ) through the cross section by conduction, where  $a_x$  is the cross-section

area of the fin, and  $k$  is the conductivity thermal coefficient. According to Newton's law, it is possible to improve the heat exchange to increase the  $a_x$ .

$$Q = K a_x \frac{d\theta}{dl} \quad (3)$$

To obtain the heat variation with respect to the height ( $dQ/dl$ ), the derivate of equation (3) is obtained, resulting in equation (4).

$$\frac{dQ}{dl} = K a_x \frac{d^2\theta}{dl^2} \quad (4)$$

We used the geometry of the Koch snowflake to increase surface, and thus improve the heat transfer of a tube with conventional extended surface. The Koch snowflake sketch was built up to generation 12 to preserve the self-similarity configuration from the location of three copies of the Koch curve (Fig. 2). The Koch curve can be found as the division of three same parts of a line, with the middle line being replaced by an equilateral triangle; this process is repeated for each generation, at each segment obtained in the previous generation [22].

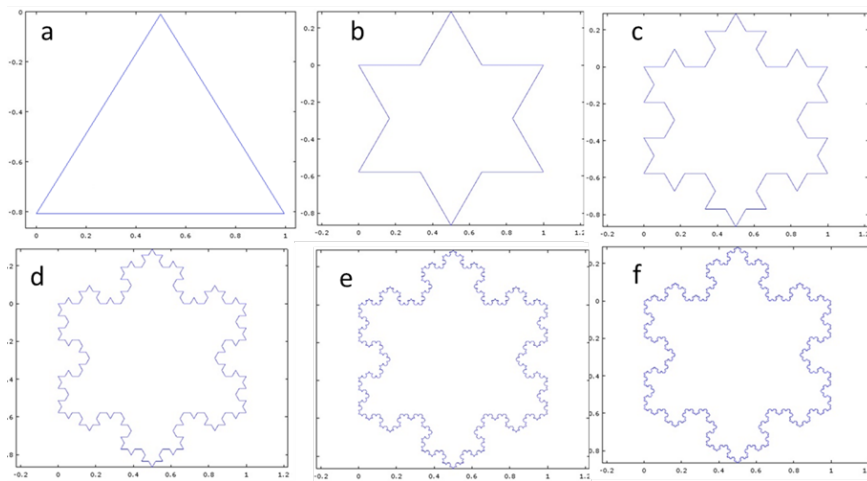

FIG. 2. Koch snowflake fractal geometry: a) Germen, b) Generation 1 c) Generation 2, d) Generation 3, e) Generation 4, and f) Generation 6.

Equation (5) calculates the length of each line segment ( $L$ ) at each generation ( $n$ ); here, the initial length ( $L_0$ ) corresponds to the lengths of the sides of the initial equilateral triangle.

$$L = L_0 * \left(\frac{1}{3}\right)^n \quad (5)$$

After sketching the Koch snowflake, we initiated the CAD design of the tube with extended fractal surface (Fig. 3). The elaboration of this design was limited to the sketch of the third generation, due to the increase of the tube surface, which might decrease the heat transfer.

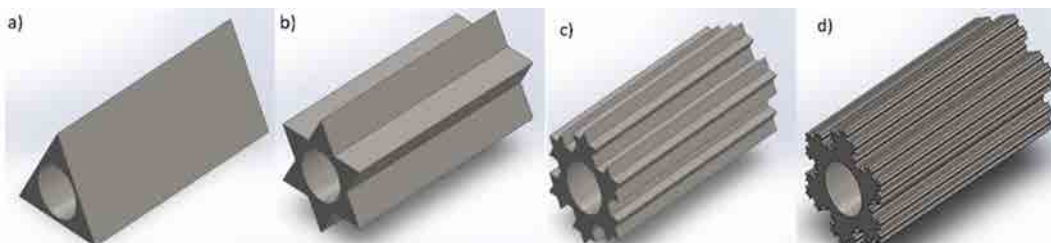

FIG. 3. CAD design of the tube with Koch snowflake extended surface: a) Initial generation, b) Generation 1, c) Generation 2, and d) Generation 3.

The Cesaro curve is considered a similar geometry to the Koch snowflake, with big affinities to extended surfaces of longitudinal fins (Fig. 4). To obtain the Cesaro curve, equation (6) is necessary, as well as the following steps: 1) draw a line with length  $L_0$ , 2) draw a line from the middle of the previous line, and 3) build an isosceles triangle with length  $L$ . Therefore, to join the Cesaro curve as an extended surface of the tube for heat exchangers, we start by using a hexagon where each side has a length  $L_0$  and the maximum fractal geometry iteration correspond to the third generation.

$$L = L_0 * \left(\frac{1}{2}\right)^n \quad (6)$$

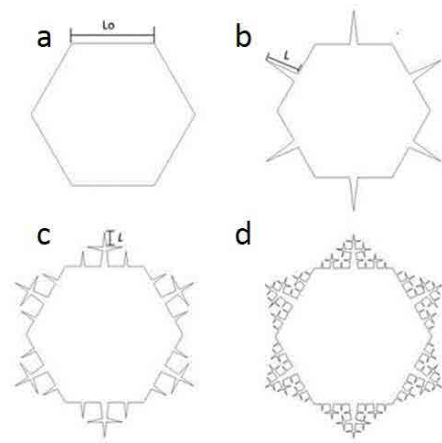

FIG. 4. Cesaro curve geometry: a) Initial generation, b) Generation 1, c) Generation 2, and d) Generation 3.

Similarly, we elaborated the CAD design by adding the Cesaro curve (Fig. 5), where the tube with each generation as an extended surface can be appreciated.

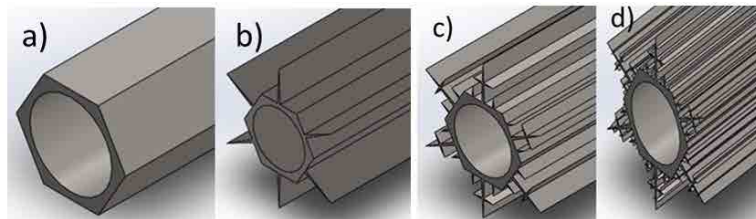

FIG. 5. CAD design of the tube with Cesaro curve as extended surface for heat transfer: a) Initial generation, b) Generation 1, c) Generation 2, and d) Generation 3.

We used SolidWorks software to design each CAD, and ANSYS software to initiate CAE finite element analysis, in order to observe the variation of heat transfer inside the tube, and the interaction between the tube with extended surface and the environment. For the simulations, we adjusted the air flow to room temperature (22 °C), indicating an internal temperature of 200 °C, and assigned to the tube a copper material with thermal conductivity of 400 W/(m°C).

### III. RESULTS

Figure 6 shows the results obtained from the analysis of finite elements, particularly the behavior of the heat flow (W/m<sup>2</sup>) in the different types of tubes.

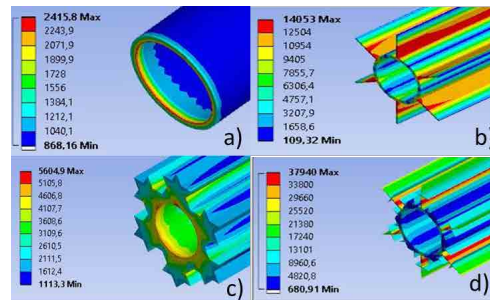

FIG. 6. Thermal flux behavior: a) smooth tube, b) tube with extended surface of six longitudinal fins, c) tube with extended surface of Koch snowflake of second generation, and d) tube with extended surface with the Cesaro curve of second generation.

Figure 7 explains the results better, showing the variation of the heat flow in each of the tubes, arranged for thermal transfer.

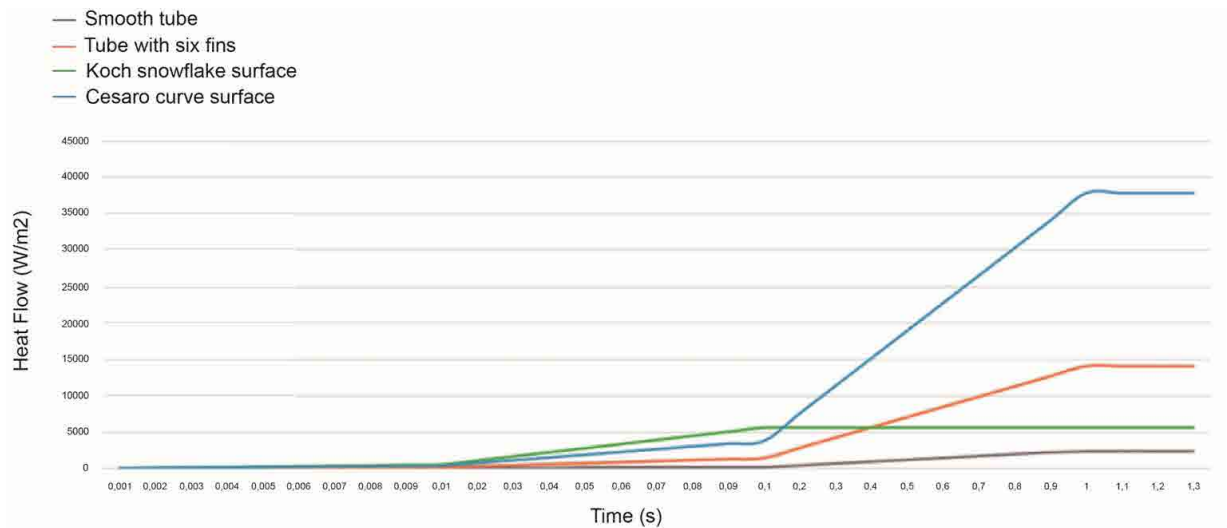

FIG. 7: Thermal analysis: smooth tube (gray line), tube with extended surface of six longitudinal fins (orange line), tube of extended surface of Koch snowflake of second generation (green line), and tube of extended surface with Cesaro curve (blue line).

## IV. DISCUSSION

The results showed that the tube with extended surface of the Cesaro curve increased the heat transfer from the inside of the tube to its surroundings; this is because the contact area of the external fluids increased, and the tube's geometry facilitated the turbulence that favors the early change of the internal and external temperatures of the tube. Although the tube with extended surface with the Koch snowflake did not surpass the heat transfer of a tube with extended surface of longitudinal fins, it would be useful when a faster heat transfer is required.

## V. CONCLUSIONS

This study showed that it is possible both to integrate fractal geometries to the field of mechanical engineering, specifically to the area of heat transfer, and to make viable designs with the support of CAD and CAE tools. Likewise, the results of this study serve as foundations to continue the research in this area, oriented toward the application in devices that exchange heat at industrial, automotive, and household level, such as heaters, boilers, and radiators; and with the goal of offering to the market new devices able to handle high temperature in short times.

## ACKNOWLEDGMENT

This study was carried out thanks to funds by the research vice-rectory of the Universidad Militar Nueva Granada (INV\_ING 2117) to the project “*Diseño de estructuras fractales para ingeniería*,” during 2016.

## REFERENCES

- [1] R. Senthilkumar, S. Prabhu, and M. Cheralathan, “Experimental investigation on carbon nano tubes coated brass rectangular extended surfaces,” *Applied Thermal Engineering*, vol. 50(1), pp. 1361-1368, Jan. 2013. DOI: <http://doi.org/10.1016/j.applthermaleng.2012.05.040>.
- [2] S. W. Chang, W. L. Cai, and R. S. Syu, “Heat transfer and pressure drop measurements for tubes fitted with twin and four twisted fins on rod,” *Experimental Thermal and Fluid Science*, vol. 74, pp. 220-234, Jun. 2016. DOI: <http://doi.org/10.1016/j.expthermflusci.2016.01.001>.
- [3] B. Niezgodna – Zelasko, and J. Zelasko, “Refrigerant boiling at low heat flux in vertical tubes with heat transfer enhancing fittings,” *International Journal of Refrigeration*, vol. 54, pp. 151-169, Jun. 2015. DOI: <http://doi.org/10.1016/j.ijrefrig.2015.03.007>.
- [4] E. Gkanas, and Makridis, “Effective thermal management of a cylindrical MgH<sub>2</sub> tank including thermal coupling with an operating SOFC and the usage of extended surfaces during the dehydrogenation process,” *International Journal of Hydrogen Energy*,



- vol. 41(13), pp. 5693-5708, Apr. 2016. DOI: <http://doi.org/10.1016/j.ijhydene.2016.01.165>.
- [5] H. W. Carpenter, and R. G. Reid, "The response of layered anisotropic tubes to centrifugal loading," *Composite Structures*, vol. 139, pp. 141-150, Apr. 2016. DOI: <http://doi.org/10.1016/j.compstruct.2015.11.071>.
- [6] K. Yang, S. Xu, J. Shen, S. Zhou, and Y. M. Xie, "Energy absorption of thin-walled tubes with pre-folded origami patterns: Numerical simulation and experimental verification," *Thin-Walled Structures*, vol. 103, pp. 33-44, Jun. 2016. DOI: <http://doi.org/10.1016/j.tws.2016.02.007>.
- [7] R. Romero-Méndez, P. Lara-Vázquez, F. Oviedo-Tolentino, H. M. Duran-García, F. G. Pérez-Gutiérrez, and A. Pacheco-Vega, "Use of Artificial Neural Networks for Prediction of the Convective Heat Transfer Coefficient in Evaporative Mini-Tubes," *Ingeniería, Investigación y Tecnología*, vol. 17(1), pp. 23-34, Jan. 2016. DOI: <http://doi.org/10.1016/j.riit.2016.01.003>.
- [8] S. Jedari Salami, "Extended high order sandwich panel theory for bending analysis of sandwich beams with carbon nanotube reinforced face sheets," *Physica E: Low-dimensional Systems and Nanostructures*, vol. 76, pp. 187-197, Feb. 2016. DOI: <http://doi.org/10.1016/j.physe.2015.10.015>.
- [9] S. Rimza, K. Satpathy, S. Khirwadkar, and K. Velusamy, "Optimal design of divertor heat sink with different geometric configurations of sectorial extended surfaces," *Fusion Engineering and Design*, vol. 100, pp. 581-595, Nov. 2015. DOI: <http://doi.org/10.1016/j.fusengdes.2015.08.008>.
- [10] B. Anoop, C. Balaji, Velusamu, and K. Velusamy, "A characteristic correlation for heat transfer over serrated finned tubes," *Annals of Nuclear Energy*, vol. 85, pp. 1052-1065, Nov. 2015. DOI: <http://doi.org/10.1016/j.anucene.2015.07.025>.
- [11] P. A. Di Maio, P. Arena, G. Bongiovi, P. Chiovaro, A. del Nevo, and R. Forte, "Optimization of the breeder zone cooling tubes of the DEMO Water-Cooled Lithium Lead breeding blanket," *Fusion Engineering and Design*, vol. 109-111(A), pp. 227-231, Nov. 2016. DOI: <http://doi.org/10.1016/j.fusengdes.2016.03.021>.
- [12] S. Mirfendereski, A. Abbassi, and M. Saffar - Avval, "Experimental and numerical investigation of nanofluid heat transfer in helically coiled tubes at constant wall heat flux," *Advanced Powder Technology*, vol. 26(5), pp. 1483-1494, Sep. 2015. DOI: <http://doi.org/10.1016/j.apt.2015.08.006>.
- [13] D. J. Kukulka, and R. Smith, "Thermal-hydraulic performance of Vipertex 1EHT enhanced heat transfer tubes," *Applied Thermal Engineering*, vol. 61(1), pp. 60-66, Oct. 2013. DOI: <http://doi.org/10.1016/j.applthermaleng.2012.12.037>.
- [14] J. Yan, Q. Bi, G. Zhu, L. Cai, Q. Yuan, and H. Lv, "Critical heat flux of highly subcooled water flow boiling in circular tubes with and without internal twisted tapes under high mass fluxes," *International Journal of Heat and Mass Transfer*, vol. 95, pp. 606-619, Apr. 2016. DOI: <http://doi.org/10.1016/j.ijheatmasstransfer.2015.12.024>.
- [15] J. Yan, Q. Bi, L. Cai, G. Zhu, and Q. Yuan, "Subcooled flow boiling heat transfer of water in circular tubes with twisted-tape inserts under high heat fluxes," *Experimental Thermal and Fluid Science*, vol. 68, pp. 11-21, Nov. 2015. DOI: <http://doi.org/10.1016/j.expthermflusci.2015.04.003>.
- [16] B. Li, X. Han, Z. Wan, X. Wang, and Y. Tang, "Influence of ultrasound on heat transfer of copper tubes with different surface characteristics in sub-cooled boiling," *Applied Thermal Engineering*, vol. 92, pp. 93-103, Jan. 2016. DOI: <http://doi.org/10.1016/j.applthermaleng.2015.09.069>.
- [17] V. Garcia-Morales, "Fractal surfaces from simple arithmetic operations," *Physica A: Statistical Mechanics and its Applications*, vol. 447, pp. 535-544, Apr. 2016. DOI: <http://doi.org/10.1016/j.physa.2015.12.028>.
- [18] I. M. Rian, and S. Asayama, "Computational Design of a nature-inspired architectural structure using the concepts of self-similar and random fractals," *Automation in Construction*, vol. 66, pp. 43-58, Jun. 2016. DOI: <http://doi.org/10.1016/j.autcon.2016.03.010>.
- [19] H. Khezzzadeh, "Overall properties of particulate composites with fractal distribution of fibers," *Mechanics of Materials*, vol. 96, pp. 1-11, May. 2016. DOI: <http://doi.org/10.1016/j.mechmat.2016.01.014>.
- [20] G. Pia, L. Casnedi, R. Ricci, L. A. Besalduch, O. Cocco, A. Murru, Paola Meloni, and U. Sanna, "Thermal properties of porous stones in cultural heritage: Experimental findings and predictions using an intermingled fractal units model," *Energy and Buildings*, vol. 118, pp. 232-239, Apr. 2016. DOI: <http://doi.org/10.1016/j.enbuild.2016.03.011>.
- [21] N. Nagarani, K. Mayilsamy, A. Murugesan, and G. Sathesh Kumar, "Review of utilization of extended surfaces in heat transfer problems," *Renewable and Sustainable Energy Reviews*, vol. 29, pp. 604-613, Jan. 2014. DOI: <http://doi.org/10.1016/j.rser.2013.08.068>.
- [22] M. L. Lapidus, and R. G. Niemeyer, "Towards the Koch Snowflake Fractal Billard: Computer Experiments and Mathematical Conjectures," *Contemporary Mathematics*, vol. 517, pp. 231-265, Jan. 2010. DOI: <http://doi.org/10.1090/conm/517/1014>.