

CUADERNOS DE ECONOMÍA

ISSN 0121-4772

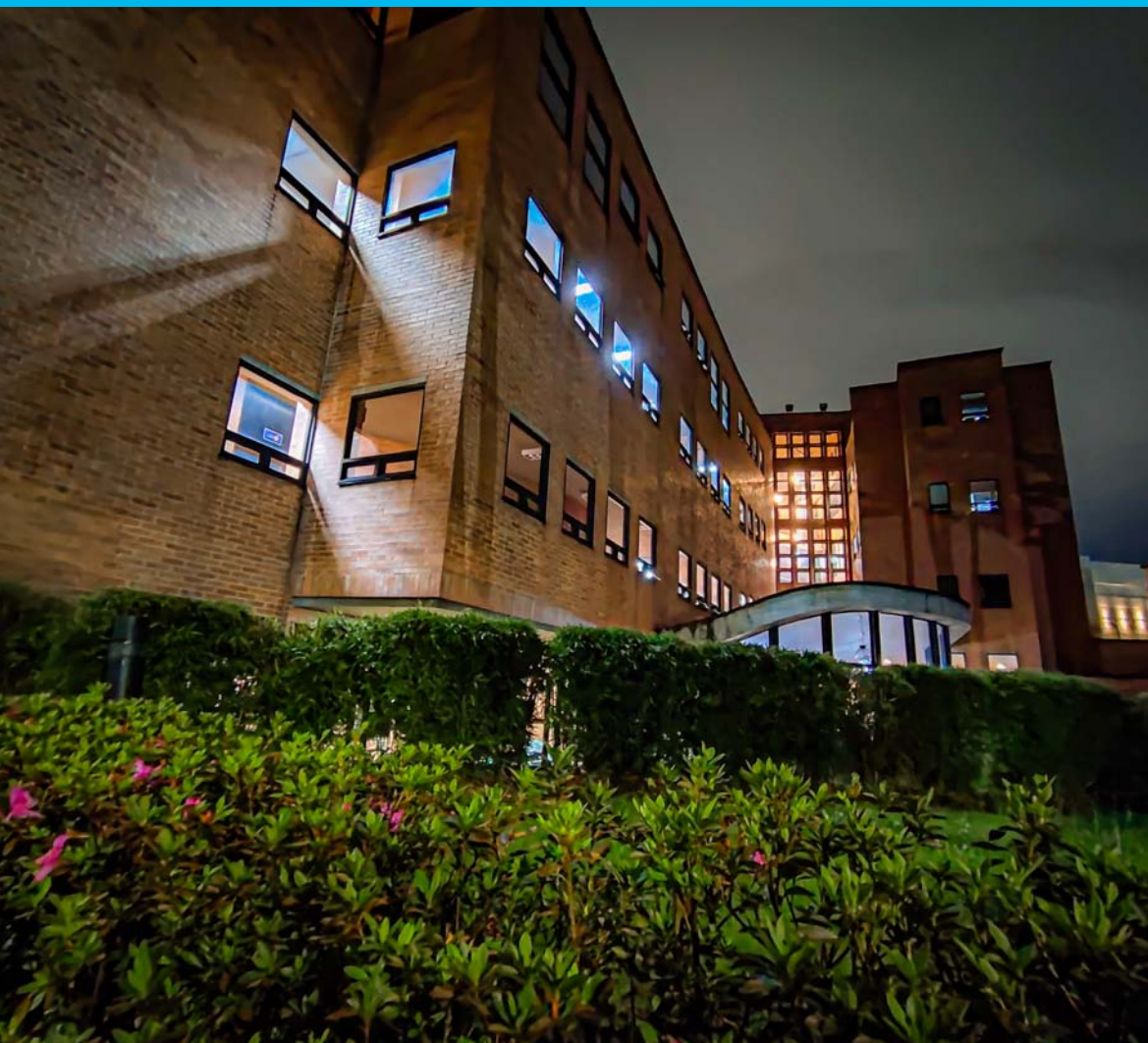

Facultad de Ciencias Económicas
Escuela de Economía
Sede Bogotá



UNIVERSIDAD
NACIONAL
DE COLOMBIA

ASESORES EXTERNOS

COMITÉ CIENTÍFICO

Ernesto Cárdenas

Pontificia Universidad Javeriana-Calí

José Félix Cataño

Universidad de los Andes

Philippe De Lombaerde

NEOMA Business School y UNU-CRIS

Edith Klímovsky

Universidad Autónoma Metropolitana de México

José Manuel Menudo

Universidad Pablo de Olavide

Gabriel Mísa

Universidad Nacional de Colombia

Mauricio Pérez Salazar

Universidad Externado de Colombia

Fábio Waltenberg

Universidade Federal Fluminense de Rio de Janeiro

EQUIPO EDITORIAL

Daniela Cárdenas

Karen Tatiana Rodríguez

Andrés Díaz

Estudiante auxiliar

Proceditor Ltda.

Corrección de estilo, traducción, armada electrónica,
finalización de arte, impresión y acabados
Tel. 757 9200, Bogotá D. C.

Luis Tarapuez

Área de Comunicaciones - Facultad de Ciencias Económicas

Fotografía de la cubierta

Indexación, resúmenes o referencias en

SCOPUS

Thomson Reuters Web of Science

(antiguo ISI)-SciELO Citation Index

ESCI (Emerging Sources Citation Index) - Clarivate Analytics

EBSCO

Publindex - Categoría B - Colciencias

SciELO Social Sciences - Brasil

RePEc - Research Papers in Economics

SSRN - Social Sciences Research Network

EconLit - Journal of Economic Literature

IBSS - International Bibliography of the Social Sciences

PAIS International - CSA Public Affairs Information Service

CLASE - Citas Latinoamericanas en Ciencias Sociales y Humanidades

Latindex - Sistema regional de información en línea

HLAS - Handbook of Latin American Studies

DOAJ - Directory of Open Access Journals

CAPEs - Portal Brasileiro de Informação Científica

CIBERA - Biblioteca Virtual Iberoamericana España / Portugal

DIALNET - Hemeroteca Virtual

Ulrich's Directory

DOTEC - Documentos Técnicos en Economía - Colombia

LatAm-Studies - Estudios Latinoamericanos

Redalyc

Universidad Nacional de Colombia

Carrera 30 No. 45-03, Edificio 310, primer piso

Correo electrónico: revcuaeo_bog@unal.edu.co

Página web: www.economia.unal.edu.co

Teléfono: (571)3165000 ext. 12308, AA. 055051, Bogotá D. C., Colombia

Cuadernos de Economía Vol. 42 No. 89 - 2023

El material de esta revista puede ser reproducido citando la fuente. El contenido de los artículos es responsabilidad de sus autores y no compromete de ninguna manera a la Escuela de Economía, ni a la Facultad de Ciencias Económicas, ni a la Universidad Nacional de Colombia.

UNIVERSIDAD NACIONAL DE COLOMBIA

Rectora

Dolly Montoya Castaño

Vicerrector Sede Bogotá

Jaime Franky Rodríguez

FACULTAD DE CIENCIAS ECONÓMICAS

Decana

Juanita Villaveces

ESCUELA DE ECONOMÍA

Directora

Nancy Milena Hoyos Gómez

CENTRO DE INVESTIGACIONES PARA EL DESARROLLO

- CID

Karoll Gómez

DOCTORADO Y MAestrÍA EN CIENCIAS ECONÓMICAS Y PROGRAMA CURRICULAR DE ECONOMÍA

Coordinadora

Olga Lucía Manrique

CUADERNOS DE ECONOMÍA

EDITOR

Gonzalo Cóbbita

Universidad Nacional de Colombia

CONSEJO EDITORIAL

Juan Carlos Córdoba

Iowa State University

Liliana Chicaiza

Universidad Nacional de Colombia

Paula Herrera Idárraga

Pontificia Universidad Javeriana

Juan Miguel Gallego

Universidad del Rosario

Mario García

Universidad Nacional de Colombia

Iván Hernández

Universidad de Ibagué

Iván Montoya

Universidad Nacional de Colombia, Medellín

Juan Carlos Moreno Bríd

Universidad Nacional Autónoma de México

Manuel Muñoz

Universidad Nacional de Colombia

Ömer Özak

Southern Methodist University

María Ripoll

Universidad de Pittsburgh

Juanita Villaveces

Universidad Nacional de Colombia

Esta obra está bajo una Licencia Creative Commons Atribución-NoComercial-SinDerivadas 2.5 Colombia.

Usted es libre de:

Compartir - copiar, distribuir, ejecutar y comunicar públicamente la obra

Bajo las condiciones siguientes:

- **Atribución** — Debe reconocer los créditos de la obra de la manera especificada por el autor o el licenciante. Si utiliza parte o la totalidad de esta investigación tiene que especificar la fuente.
- **No Comercial** — No puede utilizar esta obra para fines comerciales.
- **Sin Obras Derivadas** — No se puede alterar, transformar o generar una obra derivada a partir de esta obra.

Los derechos derivados de usos legítimos u otras limitaciones reconocidas por la ley no se ven afectados por lo anterior.



El contenido de los artículos y reseñas publicadas es responsabilidad de los autores y no refleja el punto de vista u opinión de la Escuela de Economía de la Facultad de Ciencias Económicas o de la Universidad Nacional de Colombia.

The content of all published articles and reviews does not reflect the official opinion of the Faculty of Economic Sciences at the School of Economics, or those of the Universidad Nacional de Colombia. Responsibility for the information and views expressed in the articles and reviews lies entirely with the author(s).

**ECONOMIC GROWTH REGIMES:
EVIDENCE FROM LATIN AMERICA**

Carlos Dabús
Fernando Delbianco

Dabús, C., & Delbianco, F. (2023). Economic growth regimes: Evidence from Latin America. *Cuadernos de Economía*, 42(89), 129-146.

This paper studies the effect of economic instability, income inequality and openness in the transition to different growth regimes for 18 Latin American countries during the 1980-2014 period. The study is carried out determining three different levels: low, middle and high economic growth. The countries are categorised according to the method of k-median clustering. We use panel data estimation applying random effects model and ordered logit. The results indicate that instabil-

C. Dabús

Departamento de Economía (UNS) - IIESS, CONICET, Bahía Blanca, Argentina. Email: cdabus@criba.edu.ar

F. Delbianco

Departamento de Economía (UNS) - INMABB, CONICET, Bahía Blanca, Argentina. Email: fernando.delbianco@uns.edu.ar (corresponding author).

Suggested citation: Dabús, C., & Delbianco, F. (2023). Economic growth regimes: Evidence from Latin America. *Cuadernos de Economía*, 42(89), 129-146. <https://doi.org/10.15446/cuad.econ.v42n89.94817>

This paper was received on April 1, 2021, revised on November 5, 2021, and finally accepted on May 20, 2022.

ity and inequality negatively affect the economic performance of the region, while openness is not a significant factor in explaining economic growth.

Keywords: Growth regimes; economic instability; income inequality; Latin America.

JEL: O4, E3, E5, E6.

Dabús, C., & Delbianco, F. (2023). Regímenes de crecimiento económico: evidencia de Latinoamérica. *Cuadernos de Economía*, 42(89), 129-146.

En este artículo se estudia el efecto de la inestabilidad económica, la desigualdad y la apertura en la transición a diferentes regímenes de crecimiento para 18 países de América Latina en el período 1980-2014. Este artículo define tres niveles: crecimiento económico bajo, medio y alto. Los países se categorizan mediante análisis de clústeres. Usamos datos de panel aplicando efectos aleatorios y logit ordenado como técnicas de estimación. Los resultados indican que la inestabilidad afecta negativamente el rendimiento económico de la región, mientras que la apertura no resulta significativa.

Palabras clave: regímenes de crecimiento; inestabilidad económica; desigualdad de ingresos; América Latina.

JEL: O4, E3, E5, E6.

INTRODUCTION

The economic growth determinants of developing countries, in Latin America in particular, have been broadly studied in the literature. Several explanatory factors are relevant in explaining the economic performance of emerging economies. Successively, this region has experienced different stages of fast growth and prolonged stagnation. This particular economic performance is the main motivation for this study. Indeed, this paper studies what causes the different economic growth phases throughout the history of the Latin American countries. In this sense, the contribution here is to establish the main factors that propel and determine that the countries converge to regimes of high economic growth or to stages of prolonged stagnation. This differs from the traditional cross country of temporal series approaches. As the empirical study is carried out based on the segmentation of the total sample in different growth regimes, the advantage being that this allows identifying with more precision the factors that propel and are behind the stages of fast or slow economic growth.

Taking this into account, the results obtained from this research should be more plausible than those obtained from works that applied the traditional approach of the determinants of economic growth. In this regard, the evidence found here indicates that the volatility of output growth rate is the key factor behind the regimes of lower growth. Higher volatility implies that the economy transits to a lower growth regimes. High economic instability should discourage investment, which then reduces economic growth. Successively, income inequality is also related to lower growth regimes. According to the political approach referenced below high inequality generates social discontent, which in most cases reduces the duration of the governments in power so that these are more inclined to prioritise current consumption over investment, thereby reducing long-term growth. Openness is not significant, which for the particular case of Latin America can be explained by the difficulties and ultimately by the bankruptcy of the domestic industry provoked by low price imports offsetting the higher competitiveness and productivity associated with aperture. Hence, the growth promoting effects of aperture could be annulled by the negative impact on local production. Finally, neither is inflation significant, which is a surprising result although it can be related to the fact that the output growth rate volatility absorbs the total effect of economic instability.

In short, the results found here seem to indicate that in order to achieve regimes of high economic growth it is necessary to apply policies that reduce income inequality in order to avoid social unrest, as well as anticyclical policies in order to minimise the amplitude of economic cycles. Based on the evidence obtained in this study, both positions should favour investment and growth.

On the other hand, in relation to the specific work carried out in this paper, in an extension of Dabús et al. (2016) explanatory variables such as income inequality, economic instability and the degree of economic openness are included. Consecutively, contrasting with Dabús et al. (2016), we determine the probability of

staying in a certain growth regime at different values of the explanatory variables mentioned above. In particular, the hypothesis put forth is that higher levels of income inequality, economic instability and a lower degree of openness imply that the countries of the region remain in lower economic growth regimes. In particular, our results only partially confirm said hypothesis. They indicate that mainly the macroeconomic volatility (approximated by the variability of the growth rate) and income inequality lead the economy to lower growth regimes, while investment favours the transit to upper growth regimes; moreover, inflation and economic openness are not significant. This last result is similar to Astorga (2010), who, in a long-term study of the economic growth determinants for Latin America, found that openness is not significant in explaining economic growth.

Generally, the lack of consensus in the literature regarding the key factors of the stages of high growth and stagnation mentioned in the following section suggests that the determinants of economic growth deserve additional study, in particular in a region such as Latin America. This region presents a low degree of openness, and accordingly a possible external restriction that limits expansion. Historically, it has a high inequality of income distribution, and has weathered macroeconomic instability, as well as different regimes of stagnation and rapid economic growth. In this sense, the aim of this paper is to investigate the effects of openness, income inequality and economic instability on growth in the region in the long-term, in particular during the 1980-2014 period, for three economic growth regimes: high, intermediate and low growth.

The structure of this document is as follows. The following section presents a review of the literature on the topic under study. Then the data and the methodology are detailed. Then the results are presented and discussed, and finally the conclusions.

SURVEY OF THE LITERATURE

Although the literature has shown that numerous and varied factors can explain economic growth, Levine and Renelt (1992) found that the investment share of the GDP is particularly robust. Further to this, considering the history and the economic features of Latin America we consider three key variables potentially relevant: economic instability, the degree of openness and income inequality. In relation to the foremost, the findings presented by De Gregorio (1992) indicate that low physical and human capital accumulation as well as macroeconomic and political instability explain the meager economic growth of the region. Similarly, De Gregorio (2006) shows that macroeconomic instability damages sustained growth in Chile, while previously Martin and Rogers (2000) and Hnatkovska and Loayza (2005) presented evidence indicating that in general countries and regions with a more volatile growth rate present a poorer economic performance. More

recently, also Bermúdez et al. (2015) found that such volatility is a key factor in explaining Latin American stagnation in the long-term.¹

With regard to economic openness, a potential constraint for economic growth in the region can be external restriction, that is, a poor export performance that limits the insertion of Latin America into the world market, as well as a sustained economic growth. In this sense, the literature on the openness-growth relationship presents mixed evidence. On the one hand, Harrison (1996), with a sample of developing countries, finds a positive association between growth and different measures of openness. Similarly, Liu et al. (1997) for the case of China show a bi-directional causal relationship between openness and growth, while Oskooee and Niroomand (1999) present evidence using a wide sample of countries, of a positive long-term relationship between both variables. For their part, Ekanayake et al. (2003) show a bi-directional causality between the increase of exports and economic growth, and in a similar sense more recently Sakyi et al. (2015) assert a positive bi-directional relationship between trade openness and income level in the long-term.

Previously, Edwards (1992) found that economies that are more open grow faster than those with trade distortions do, and Edwards (1998), in a comparative analysis for 93 countries, shows that countries that are more open present higher productivity growth. Gundlach (1997) confirms that openness has a strong positive effect on economic growth, in particular in developing countries. Similarly, Yanikkaya (2003) and Karras (2003) find that openness promotes economic growth. Conversely, more recently, the results presented in Hye and Lau (2015) for India indicate a negative relationship between both variables, while Ulaşan (2015), by using several openness indicators, finds that these are not related to growth.

In the case of Latin America, while Taylor (1998) and De Gregorio and Jong-Wha (1999) show that an inward-looking development strategy harms growth, Awokuse (2008) analyses the trade-economic growth relationship for Argentina, Colombia, and Peru, and states that import-led growth is particularly favourable for growth. Meanwhile, Astorga (2010) shows a negative conditional correlation between trade openness and growth, but a positive link via investment.

In short, even though in several cases the literature suggests a positive openness-economic growth relationship the evidence is still eclectic.

On the other hand, a possible explanatory factor regarding economic growth in developing countries is income inequality. The income inequality-economic growth relationship has been widely analysed in the literature. However, there is no clear consensus concerning the effect of inequality on growth. In fact, the theoretical literature presents two main opposing approaches. In first place, we have the classical theory, which postulates a positive correlation between inequality

¹ The main stylised facts regarding economic volatility and economic performance in the region can be found in Fanelli and Jiménez (2010).

and growth. This is due to the assumption that the financial saving rate is higher for the rich than for the poor population. Since increasing inequality favours the richer population income share, this should also generate higher aggregate savings, investment and correspondingly economic growth (Stiglitz, 1969).

On the contrary, the second approach, the political economic explanation, affirms that inequality harms economic growth by means of different channels, like social instability. This channel emphasises the negative role of socio-political instability for economic growth. The idea is that higher inequality raises instability, which in turn favours a more propitious environment for social unrest. This shortens the duration of the governments in power, which therefore are more inclined to prioritise current consumption over investment, reducing long-term growth (Alesina & Perotti, 1996).

Empirically, both the classical and the political economy views have support.² On the one hand, Partridge (1997), Li and Zou (1998) and Forbes (2000), provide evidence indicating that inequality favours economic growth. On the contrary, Persson and Tabellini (1994) and Deininger and Squire (1998) state that inequality is detrimental to growth. Meanwhile, De Dominicis et al. (2008), in a cross-country regressions analysis, present evidence on a negative and significant relationship between initial inequality and growth. In turn, Malinen (2013) presents a negative relation in a wide sample of countries for the 1965-2000 period. Similarly, for a sample of East Asian economies in a recent paper Birdsall et al. (1995) affirm that policies that reduced poverty and income inequality, such as emphasising high-quality basic education and augmenting labour demand, also stimulated growth.

In the same sense, Clarke (1995), Mo (2000), Panizza (2002) and Frank (2005) present evidence of a negative inequality-growth relation, while Knowles (2005) and Kefi and Zouhaier (2012) obtain similar results for a sample of developing countries. Herzer and Vollmer (2012) show a negative effect of inequality on income in the long-term, and Abida and Sghaier (2012) affirm that the long-term elasticity between growth and income inequality is negative and significant in Tunisia, Algeria, Morocco and Egypt in the 1970-2007 period. Similarly, Malinen (2012) finds that there is a long-term negative relation between growth and inequality in developed economies, while Cingano (2014) presents evidence of a negative impact of inequality on economic growth. With regard to the Indian states during the 1980-2010 period, Stewart and Moslares (2012) show that the regional Gini coefficients affect the growth rate negatively. Ostry and Berg (2011) find a more equal income distribution is related to longer periods of economic growth. Meanwhile, Ncube et al. (2014) show that income inequality reduces economic growth in the Middle East and North Africa for the 1985-2009 period. Finally,

² These opposing results can be explained by nonlinearities in the inequality-growth relationship (see Barro, 2000; Banerjee & Duflo, 2003; Chen, 2003). In particular, Lin et al. (2006) apply a nonlinear estimation using the initial real income as a threshold variable.

also Kotlánová (2015) for a sample of 34 OECD member countries in the period 2000–2012 presents evidence of a negative income inequality-economic growth relationship.

On the other hand, literature with eclectic evidence is presented in Delbianco et al. (2014), who find a negative (positive) effect of inequality on economic growth at lower (higher) income levels for a sample of Latin American countries. In a similar sense, Partridge (2005) confirms that the middle-class inequality share and overall inequality are positively related to long-term growth, but the relationship is not as strong when considering short-term effects. Conversely, Halter et al. (2014) evidence that higher inequality helps economic performance in the short-term, but it reduces growth in the future, so that the long-term effect tends to be negative. In turn, Fallah and Partridge (2007) with regard to the US find a positive link between inequality and economic growth in the metropolitan areas, but this relationship is negative in the non-metropolitan regions. Moreover, similar results are presented by Tiwari et al. (2013) for India during the 1965–2008 period. Meanwhile, Banerjee and Duflo (2003) show that inequality is favourable for growth in more egalitarian societies, but it is harmful in the case of more unequal countries, and Lin et al. (2009) find that higher inequality reduces economic growth in low-income countries, but propels it in high-income economies.

In sum, the empirical literature indicates that evidence regarding the relationship between income inequality and economic growth is not conclusive. Moreover, the published contributions in which growth is explained by instability, openness and inequality do not arrive at a clear consensus on the relationship between these variables. Thus, the empirical research carried out in section IV intends to shed some light on this issue by means of the estimation of growth determinants based on the economic growth regimes approach, as previously explained.

DATA AND METHODOLOGY

We apply a panel data approach for 18 Latin American countries for the 1980–2014 period. The list of countries consists of Argentina, Bolivia, Brazil, Chile, Colombia, Costa Rica, Dominican Republic, Ecuador, El Salvador, Guatemala, Honduras, Mexico, Nicaragua, Panama, Paraguay, Peru, Uruguay and Venezuela. The source of our variables is the World Bank, except for the inflation rate, which was extracted from CEPAL. All variables are measured as quinquennial averages. Some basic descriptive statistics are shown on Table 1.

Table 1 shows the average values of growth and the share of investment to the GDP in the region. Also, there exists a great dispersion of the variables under study, and in particular of the Gini coefficient, the openness and the inflation rate, which could indicate an important instability during the period under study in Latin America.

Table 1.

Descriptive statistics (1980-2014, quinquennial averages)

Variable	Obs	Average	Standard Deviation	Minimum	Maximum
GDP PC Growth	126	3,2	2,3	-5,1	8,3
Gini	105	51,5	6,9	40,2	59,9
Investment/GDP	124	20,3	4,0	12,6	32,1
Inflation (CEPAL)	124	119,8	428,1	0,5	2728,5
Openness	126	44,8	21,5	12,2	112,0
Volatility of Growth	126	3,2	2,1	0,3	11,0

Source: Author's own elaboration based on Dabús et al. (2016).

The dependent variable, i.e. the economic growth regimes, is based on instability, measured by the standard deviation of the growth rate and the inflation rate, the economic openness, measured by both imports plus exports as a percentage of the GDP, the economic (income) inequality (i.e. GINI), and finally, following Levine and Renelt (1992), the share of investment to the GDP as control variable.

Growth regimes are built on the results stemming from applying a k-median clustering to the growth rate, as in Dabús et al. (2016). The clustering in the mentioned work is performed by grouping the countries according to the growth rate using the cluster function in Stata and selecting three clusters³. This technique selects the resulting groups by minimising the squared sum of the distances between the observations and the group's centroid (e.g. mean or median). By doing this the dependent variables are discretised and growth regimes are created endogenously, without an ad-hoc definition. This results in three groups, of high, intermediate and low growth, with means of 5.1%, 2.4% and -1.3% respectively. Successively, we choose median clustering instead of k-mean to avoid the influence of outliers.

With the clusters results as input, we define the growth regimes in two different forms. This leads us to a different estimation technique for each specification, and more robustness when we test our hypothesis. First of all, we elaborate two indicator variables, one denoting the high state of growth regime (versus medium and low regimes), and another for low regimes of economic growth (versus medium and high levels). These variables are then regressed against the above mentioned explicatives in a panel probit approach (Baltagi, 2009), which allows us to maintain the panel data approach, while we regress a dummy variable as we would do in logit or probit regressions. In this context, we use both random effects⁴ and pop-

³ Only the economic growth rate was used to define the clusters, mainly in order to fulfil the task of creating the growth's regimes and then avoiding any endogeneity issues with the regressors.

⁴ In Dabus et al. (2016), with the same data, the F-test of fixed effects versus random effects determines that the hypothesis of zero covariance between the heterogeneity and the covariables is not rejected (with a p-value of 0.3788).

ulation averaged estimation for robustness. We use *xtprobit* function in Stata, that fits via maximum likelihood the random-effects model:

$$\Pr(y_{it} \neq 0 \mid \mathbf{x}_{it}) = \Phi(\mathbf{x}_{it}\boldsymbol{\beta} + \nu_i)$$

for $i = 1, \dots, n$ panels, where $t = 1, \dots, n_i$, ν_i are i.i.d., $N(0, \sigma_\nu^2)$ and Φ is the standard cumulative probability distribution.

Secondly, we use an ordinal approach, with a cardinal variable of growth regime, with values from 1 to 3 indicating a low, intermediate and high growth rate respectively. In this case, maintaining the explicative function previously described, we move to an ordered logit and a generalised ordered logit. In this approach there is a trade-off, because we lose the panel structure, but we specifically gain the logical order, which implies that to move from a low to a high regime, probably involves moving through an intermediate growth regime. The difference between the classic ordinal and the generalised ordinal is that this latter method gives us different estimations in each value as the cardinal variable moves upwards. In other words, this means that the vector of parameters is not unique for the entire space of the ordinal dependent variable. In this way, the methodology can capture different effects of the explanatory variables in each change of regime. The ordinal models formally correspond to the function:

$$\Pr(\text{regime} = i) = \Pr(\kappa_{i-1} < \beta_1 x_{1j} + \dots + \beta_k x_{kj} + u_j \leq \kappa_i)$$

for the i -th regime, with the linear model plus a normal error defining the probability of being between two cut points given by $\kappa_0, \kappa_1, \dots, \kappa_{k-1}$, where k is the number of regimes and parameters are estimated as the β coefficients (Cameron and Trivedi, 2005). The generalised method instead estimates a different set of β coefficients for each interval defined by the k_k thresholds.

EMPIRICAL EVIDENCE

The results obtained are shown on Tables 2, 3 and 4. Table 2 shows the random effects, both for the indicator variable of high growth (columns 1 and 2), and for the low growth regime (columns 3 and 4), in both cases with and without constant. Secondly, Table 3 shows the same estimations but with population averaged instead of random effects (columns 5, 6, 7 and 8). In the first place, Table 4 shows the ordinal logit results (column 9), and the generalised ordinal logit results (column 10a for the results of going from low to intermediate regime, and column 10b for the final step from intermediate to high growth regime).

Not surprisingly, in most cases the share of investment to the GDP is associated with a higher probability of achieving higher growth regimes. In turn, the results are generally very similar to those found previously with panel data and ordinal logit, which suggests that the results are robust with regard to the estimation meth-

ods that we used. Economic instability, approximated by the output growth rate volatility, is significant and negative. Hence, a more unstable growth trend makes the shift to lesser growth regimes more probable. In addition, inflation is not significant in any case. This result can be due to the fact that the growth rate volatility absorbs the total effect of economic instability, as this is more relevant than the inflation for increasing the probability of changing to lower growth levels. Besides, similarly to Astorga (2010), openness is not significant, while income inequality favours the transition to minor growth states.

Table 2.

Panel probit with random effects

Variables	Random Effects			
	(1)	(2)	(3)	(4)
	High regime	High regime	Low regime	Low regime
Investment	0.0677 (0.0412)	0.0824** (0.0407)	-0.102 (0.0670)	-0.133** (0.0569)
Gini	-0.0573* (0.0299)	-0.0246* (0.0149)	0.0199 (0.0282)	0.00588 (0.0192)
Inflation	4.98e-05 (0.000381)	8.92e-05 (0.000370)	3.66e-05 (0.000614)	-1.61e-05 (0.000656)
Openness	-0.000358 (0.00705)	0.00105 (0.00712)	-0.000115 (0.0121)	-0.00265 (0.0121)
Volatility	-0.220** (0.0855)	-0.186** (0.0806)	0.276*** (0.0892)	0.260*** (0.0863)
Constant	2.158 (1.632)		-1.493 (1.848)	
Observations	105	105	105	105
Number of country	18	18	18	18

Standard errors in parentheses. *** $p < 0.01$, ** $p < 0.05$, * $p < 0.1$

In short, the investment share favours the economy achieving upper growth rates, and inequality propels the transition to lower levels. Meanwhile, inflation and openness are not significant.

On the other hand, the generalised ordered Logit gives additional insights to the previous results. The effects of output growth rate volatility are more significant when the economy is moving from low to intermediate growth regimes, than when it transits from intermediate to high ones, which implies that, as put forth by Bermúdez et al. (2015), higher economic volatility reduces the probability of accessing the high economic growth regime, as mentioned previously. Finally, inequality only negatively affects the probability of being in a high growth state, in accord with the results obtained by Malinen (2013), Ncube (2014), Kotlánová (2015), among others.

Table 3.
Panel probit with population averaged

Variables	Population Averaged			
	(5)	(6)	(7)	(8)
	High regime	High regime	Low regime	Low regime
Investment	0.0659* (0.0387)	0.0792** (0.0369)	-0.0866 (0.0590)	-0.107** (0.0499)
Gini	-0.0554** (0.0280)	-0.0235* (0.0136)	0.00343 (0.0226)	-0.00795 (0.0173)
Inflation	3.77e-05 (0.000330)	7.20e-05 (0.000324)	-0.000131 (0.000739)	-0.000213 (0.000821)
Openness	-0.000420 (0.00692)	0.000975 (0.00690)	0.000311 (0.0106)	-0.00130 (0.0105)
Volatility	-0.214*** (0.0810)	-0.180** (0.0749)	0.310*** (0.0869)	0.303*** (0.0838)
Constant	2.087 (1.571)		-1.087 (1.497)	
Observations	105	105	105	105
Number of country	18	18	18	18

Standard errors in parentheses. *** $p < 0.01$, ** $p < 0.05$, * $p < 0.1$

Although the results were obtained from a sample of several countries, these share sundry common social and economic features that make suitable the obtaining of several general regularities and suggest some policy recommendations. These are developing countries with a per capita middle-income level, a history of economic and political instability, high inequality and a small domestic market that implies the necessity of a greater insertion in the world market in order to achieve upper levels of economic growth. In this regard, the interpretation of these results seems intuitively acceptable. First, a key finding of this study is that higher volatility drives the economy to remain in a low regime of growth. The intuition is that high economic instability associated with a less predictable growth trend discourages both current and future investment projects because of the higher uncertainty regarding potential profits. This is prejudicial for investment and thus for economic performance, inducing the transit to lower growth levels. In second place, income inequality is also the trigger for the transition to lesser economic growth. In this sense, the political economic approach sustains that high inequality promotes social turmoil and generates a general discontent that shortens the duration of the governments in power. Thus, these prioritise current consumption over investment, thus reducing long-term growth. In relation to openness and inflation, the fact that these are not significant can make sense in the particular case of Latin America. Openness is not significant in any specification of the empirical study

Table 4.
Ordinal and Generalised ordinal logit results

Variables	Ordered logit	Generalised ordered logit	
	(9)	(10a)	(10b)
	Regime variable	1	2
Investment	0.12** (0.06)	0.26* (0.14)	0.11* (0.06)
Gini	-0.07* (0.04)	-0.02 (0.05)	-0.09** (0.04)
Inflation	-0.00 (0.00)	-0.00 (0.00)	-0.00 (0.00)
Openness	-0.00 (0.01)	-0.00 (0.02)	-0.00 (0.01)
Volatility	-0.41*** (0.11)	-0.52*** (0.16)	-0.34** (0.13)
Constant cut1	-5.37** (2.34)		
Constant cut2	-2.37 (2.28)		
Constant		0.74 (3.35)	3.51 (2.43)
Observations	105	105	105

Standard errors in parentheses. *** $p < 0.01$, ** $p < 0.05$, * $p < 0.1$

(panel probit or generalised ordinal regressions). This indicates that this result is robust to different econometric specifications. In this sense, the effects of openness seem to be ambiguous. On one hand, this should be growth promoting because this is related to growing exports as well as to a higher level of competitiveness because of the fact that the economy is exposed to foreign competition. Nonetheless, in the particular case of Latin America higher levels of openness could provoke the massive bankruptcy of the domestic industry provoked by the low level of competitiveness of Latin American countries in comparison to both technologically advanced and low labour cost countries such as those of the South Asian region. This negative effect, added to the external restriction that limits the economic expansion of the above-mentioned region, can offset the beneficial effects coming from a higher insertion into the world market. Thus, even though economic openness can be growth promoting within a particular regime, this is not enough to change to an upper growth regime.⁵ Finally, the fact that inflation is not significant in explain-

⁵ Moreover, as it is reported in Dabús and Delbianco (2019), the literature regarding the role of openness is not conclusive. For example, there is evidence that indicates a positive effect Karras (2003), Mercan et al. (2013), Dao (2014) and Vogiatzoglou and Nguyen (2016), among others.

ing the transition to regimes of lower economic growth can be understood based on the fact that the negative effects of uncertainty, associated with instability in the trend of economic growth, is more relevant to propel said transition. In this way, the growth rate volatility should absorb the total effect of economic instability.

To summarise, the results set forth here allow proposing various policy recommendations. First, in order to achieve regimes of high economic growth it is necessary to reduce high levels of global income inequality. This should avoid a generalised social unrest that provokes public decisions tending to stimulate current consumption at the expense of investment and future growth. Moreover, the negative impact of output growth rate variability indicates that policy recommendations are that economic policy must be oriented to minimise the magnitude of economic cycles, such as the volatility of economic growth. Hence, anticyclical policies are recommended in order to minimise the amplitude of economic cycles. Based on this evidence, both should favour investment and the transition to regimes of higher economic growth.

CONCLUSIONS

This paper explores the factors that propel and are the cause of the transition to regimes of different levels of economic growth in Latin America. This region encompasses a wide sample of developing countries, which are within a range of high and low middle income levels. These share a history of high economic and political instability and high income inequality, as well as a small domestic market. In particular, the study focuses on how different factors affect the probability of being in a certain regime. Similar to previous papers cited above, the results show that the volatility of the output growth rate is a key determinant in explaining lower economic growth. In particular, higher volatility implies that the economy should fall and remain in lower growth regimes. The high economic instability associated with such volatility should increase uncertainty, which is harmful for investment and growth. Moreover, the evidence also indicates that higher levels of inequality propel the transition to poorer growth regimes. The interpretation could be based on the political approach. Its viewpoint is that high inequality promotes social turmoil and generates a general discontent. This reduces the duration of the governments in power, which in response to the new environment prioritise current consumption over investment, thus reducing long-term growth.

On the other hand, economic openness and the inflation rate are not significant in explaining the probabilities of a country being in a certain growth regime. Regarding the former a possible explanation of this result is that the domestic industry of the emerging countries of the region has serious difficulties in facing foreign

Contrarily, Jin (2000), and more recently Menyah et al. (2014) and Hye and Lau (2015) carry out studies that shows the opposite effect. Similarly, for Latin America the evidence is not conclusive either. In fact, De Gregorio and Jong-Wha (1999) find that openness is favourable, while Astorga (2010) reports a negative openness-growth conditional correlation.

competition of cheaper importation, which could reduce substantially the advantages of higher competitiveness and productivity associated to a higher openness. Finally, the results show that inflation does not affect economic growth, which should be because the output growth rate volatility absorbs the total effect of economic instability, so that higher inflation levels are not enough to provoke the transit to lower growth regimes.

Based on this evidence, the recommendations of economic policy must be oriented toward emphasising the application of anticyclical policies, in order to minimise both the magnitude of economic cycles and the volatility of economic growth. In other words, during periods of economic abundance the governments must be focused on reducing global demand, and vice versa during the stages of long recessions and economic stagnation. Secondly, the results suggest the application of a distributive policy, by means of a progressive tax system and public expenditure measures tending to alleviate the situation of the poor population. This should reduce or even avoid a high concentration of income and the consequent social discontent, which causes governments to increase current consumption in detriment of investment and growth. In sum, the results of this research indicate that a more stable trend of economic growth and socially tolerable levels of inequality should be favourable in order for the economy to remain in regimes of higher growth.

Finally, future work could relate to the comparison of these regional results for Latin America with other regions or groups of countries, in order to give a wider evidence of the determinants of economic growth among different growth regimes in countries with different levels of development and endowment of economic resources, such as the poorer countries of Africa and the more dynamic Asian economies.

REFERENCES

1. Abida, Z., & Sghaier, I. (2012). Economic growth and income inequality: Empirical evidence from North African countries. *Zagreb International Review of Economics and Business*, 15(2), 29-44.
2. Alesina, A., & Perotti, R. (1996). Income distribution, political instability, and investment. *European Economic Review*, 40(6), 1203-1228.
3. Astorga, P. (2010). A century of economic growth in Latin America. *Journal of Development Economics*, 92(2), 232-243.
4. Awokuse, T. (2008). Trade openness and economic growth: Is growth export-led or import-led? *Applied Economics*, 40(2), 161-173.
5. Baltagi, B. H. 2009. *A companion to econometric analysis of panel data*. Wiley.
6. Barnejee, A., & Duflo, E. (2003). Inequality and growth: What can the data say? *Journal of Economic Growth*, 8, 267-299.

7. Barro, R. (2000). Inequality and growth in a panel of countries. *Journal of Economic Growth*, 5, 5-32.
8. Bermúdez, C., Dabús, C., & González, G. (2015). Reexamining the link between instability and growth in Latin America: a dynamic panel data estimation using k-median clusters. *Latin America Journal of Economics*, 52(1), 1-23.
9. Birdsall, N., Ross, D., & Sabot, R. (1995). Inequality and growth reconsidered: Lessons from East Asia. *The World Bank Economic Review*, 9(3), 477-508.
10. Cameron, A. C., & Trivedi, P. K. (2005). *Microeconometrics: Methods and applications*. Cambridge University Press.
11. Chen, B. (2003). An inverted-U relationship between inequality and long-run growth. *Economic Letters*, 78(2), 205-212.
12. Cingano, F. (2014). *Trends in Income Inequality and its Impact on Economic Growth*, OECD Social (Employment and Migration Working Paper No. 163).
13. Clarke, G. (1995). More evidence on income distribution and growth. *Journal of Development Economics*, 47(2), 403-427.
14. Dabús, C., Delbianco, F., & Monterubbianesi, P. (2016). Inestabilidad, crecimiento y desempeño económico: evidencia de 17 países de América Latina, 1980-2014. *Semestre Económico*, 19(41), 117-136.
15. Dabús, C., & Delbianco, F. (2019). Exports, terms of trade and economic growth: Evidence from countries with different level of openness. *Journal of Reviews on Global Economics*, 8, 327-336.
16. De Dominicis, L., Florax, R., & De Groot, H. (2008). A meta-analysis on the relationship between income inequality and economic growth. *Scottish Journal of Political Economy*, 55(5), 654-682.
17. De Gregorio, J. (1992). Economic growth in Latin America. *Journal of Development Economics*, 39, 59-84.
18. De Gregorio, J., & Jong-Wha, L. (1999). *Economic growth in Latin America: Sources and prospects*. Paper prepared for the Global Development Network, 1-39.
19. De Gregorio, J. (2006). *Algunas reflexiones sobre el crecimiento económico en Chile* (Economic Policy Papers, 20). Banco Central de Chile.
20. Deininger, K., & Squire, L. (1998). New ways of looking at old issues: Inequality and growth. *Journal of Development Economics*, 57, 259-287.
21. Delbianco, F., Dabús, C., & Caraballo Pou, M. (2014). Income inequality and economic growth: New evidence from Latin America. *Cuadernos de Economía*, 33(63), 381-397.
22. Dao, A. (2014). Trade openness and economic growth. Illinois Wesleyan University Economics Department Working Papers.

23. Edwards, S. (1992). Trade orientation, distortions and growth in developing countries. *Journal of Development Economics*, 39(1), 31-57.
24. Edwards, S. (1998). Openness, productivity and growth: What do we really know? *The Economic Journal*, 108(447), 383-398.
25. Ekanayake, E. M., Vogel, R., & Bala, V. (2003): Openness and economic growth: Empirical evidence on the relationship between output, inward FDI, and trade. *Journal of Business Strategies*, 20 (1), 59-72.
26. Fallah, B., & Partridge, M. (2007). The elusive inequality-economic growth relationship: Are there differences between cities and the countryside? *Annals of Regional Science*, Springer, 41(2), 375-400.
27. Fanelli, J., & Jiménez, J. (2010). Volatilidad macroeconómica y espacio fiscal en América Latina. In Alonso, J., & Bárcena, A. (eds.), *Retos y oportunidades ante la crisis* (pp. 157-181). Agencia Española de Cooperación Internacional para el Desarrollo (AECID).
28. Frank, M. (2005). *Income inequality and economic growth in the U.S.: A panel cointegration approach mark* (Economic Working Paper 05-03). SHSU.
29. Forbes, K. (2000). A reassessment of the relationship between inequality and growth. *American Economic Review*, 9(4), 869-887.
30. Gundlach, E. (1997) Openness and economic growth in developing countries. *Review of World Economics*, 133(3), 479-496.
31. Halter, D., Oechslin, M., & Zweimüller, J. (2014). Inequality and growth: The neglected time dimension. *Journal of Economic Growth*, 19(1), 81-104.
32. Harrison, A. (1996). Openness and growth: A time-series, cross-country analysis for developing countries. *Journal of Development Economics*, 48(2), 419-447.
33. Herzer, D., & Vollmer, S. (2012). Inequality and growth: Evidence from panel cointegration. *Journal of Economic Inequality*, 10(4), 489-503.
34. Hnatkovska, V., & Loayza, N. (2005). Volatility and growth. In Aizenman, J., & Pinto, B. (eds.), *Managing volatility and crises: A practitioner's guide* (chapter 2, pp. 65-100). Cambridge University Press.
35. Hye, Q., & Lau, W. (2015). Trade openness and economic growth: Empirical evidence from India. *Journal of Business Economics and Management*, 16(1), 188-205.
36. Jin, J. (2000). Openness and growth: An interpretation of empirical evidence from East Asian countries. *The Journal of International Trade and Economic Development*, 9(1), 5-17.
37. Karras, G. (2003). Trade openness and economic growth can we estimate the precise effect? *Applied Econometrics and International Development*, 3(1), 7-25.

38. Kefi, M., & Zouhaier, H. (2012). Inequality and economic growth. *Asian Economic and Financial Review*, 2(8), 1013-1025.
39. Knowles, S. (2005). Inequality and economic growth: The empirical relationship reconsidered in the light of comparable data. *Journal of Development Studies*, 1, 135-159.
40. Kotlánová, E. (2015). Income Inequality and Economic Growth, 13th International Scientific. *Conference Economic Policy in the European Union Member Countries* September 2-4, 2015, Czech Republic.
41. Levine, R., & Renelt, D. (1992). A sensitivity analysis of cross-country growth regressions. *American Economic Review*, 82(4), 942-963.
42. Li, H., & Zou, H. (1998). Income inequality is not harmful for growth: Theory and evidence. *Review of Development Economics*, 2, 318-334.
43. Lin, S., Huang, H., & Weng, H. (2006). A semiparametric partially linear investigation of the Kuznets' hypothesis. *Journal of Comparative Economics*, 34(3), 634-647.
44. Lin, S. C., Huang, H. C., Kim, D. H., & Yeh, C. C. (2009). Nonlinearity between inequality and growth. *Studies in Nonlinear Dynamics & Econometrics*, 13(2), 1-18.
45. Liu, X., Song, H., & Romilly, P. (1997). An empirical investigation of the causal relationship between openness and economic growth in China. *Applied Economics*, 29(12), 1679-1686.
46. Malinen, T. (2012). Estimating the long-run relationship between income inequality and economic development. *Empirical Economics*, 42, 209-233.
47. Malinen, T. (2013). Inequality and growth: Another look with a new measure and method. *Journal of International Development*, 25(1), 122-138.
48. Martin, P., & Rogers, C. (2000). Long-term growth and short-term economic instability. *European Economic Review*, 44(2), 359-381.
49. Mercan, M., Gocer, I., Bulut, S., & Dam, M. (2013). The effect of openness on economic growth for BRIC-T countries: Panel data analysis. *Eurasian Journal of Business and Economics*, 6(11), 1-14.
50. Menyah, K., Nazlioglu, S., & Wolde-Rufael, Y. (2014). Financial development, trade openness and economic growth in African countries: New insights from a panel causality approach. *Economic Modelling*, 37, 386-394.
51. Mo, P. (2000). Income inequality and economic growth. *Kyklos*, 53(3), 293-315.
52. Ncube, M., Anyanwu, J. C., & Hausken, K. (2014). Inequality, economic growth and poverty in the Middle East and North Africa (MENA). *African Development Review*, 26(3), 435-453.
53. Oskooee, M., & Niroomand, F. (1999). Openness and economic growth: An empirical investigation. *Applied Economic Letters*, 6(9), 557-561.

54. Ostry, J., & Berg, A. (2011). *Inequality and unsustainable growth; two sides of the same coin* (11/08). International Monetary Fund.
55. Panizza, U. (2002). Income inequality and economic growth: Evidence from American Data. *Journal of Economic Growth*, 7(1), 25-41.
56. Partridge, M. (1997). Is inequality harmful for growth? Comment. *American Economic Review*, 87(5), 1019-1032.
57. Partridge, M. (2005). Does income distribution affect U.S. State economic growth? *Journal of Regional Science*, 45(2), 363-394.
58. Persson, T., & Tabellini, G. (1994). Is inequality harmful for growth? *American Economic Review*, 84(3), 600-621.
59. Sakyi, D., Villaverde, J., & Maza, A. (2015). Trade openness, income levels, and economic growth: The case of developing countries, 1970-2009. *The Journal of International Trade & Economic Development*, 24(6), 860-882.
60. Stewart, R., & Moslares, C. (2012). Income inequality and economic growth: The case of Indian states 1980-2009. *Cuadernos de Economía*, 31(57), 41-64.
61. Stiglitz, J. (1969). Distribution of income and wealth among individuals. *Econometrica*, 37(3), 382-397.
62. Taylor, A. (1998). On the costs of inward-looking development: Price distortions, growth, and divergence in Latin America. *The Journal of Economic History*, 58(1), 1-28.
63. Tiwari, A., Shahbaz, M., & Faridul I. (2013). Does financial development increase rural-urban income inequality? Cointegration analysis in the case of Indian economy. *International Journal of Social Economics*, 40(2), 151-168.
64. Ulaşan, B. (2015). Trade openness and economic growth: Panel evidence. *Applied Economic Letters*, 22(2), 163-167.
65. Vogiatzoglou, K., & Nguyen, P. (2016). Economic openness and economic growth: A co-integration analysis for Asean-5 countries. *The European Journal of Applied Economics*, 13(2), 10-20.
66. Yanikkaya, H. (2003). Trade openness and economic growth: A cross-country empirical investigation. *Journal of Development Economics*, 72(1), 57-89.

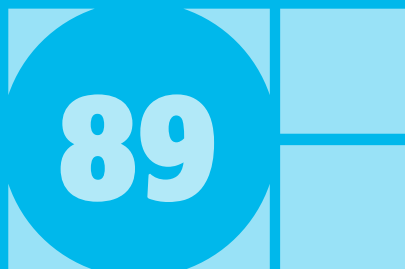

CUADERNOS DE ECONOMÍA

ISSN 0121-4772

ARTÍCULOS

- CARLOS DABÚS Y FERNANDO DELBIANCO
Economic growth regimes: Evidence from Latin America 129
- PAUL CARRILLO-MALDONADO, EMANUEL DANIEL YASELGA ALVARADO Y MARÍA ISABEL GARCÍA MOSQUERA
Un método para obtener datos de alta frecuencia del mercado laboral ecuatoriano 147
- JUAN MANUEL CANDELO-VIÁFARA Y ANDRÉS OVIEDO-GÓMEZ
La volatilidad de la moneda: un análisis de la tasa de cambio colombiana
y los mercados de materias primas energéticas 177
- NICOLÁS ESTEBAN LARA RODRÍGUEZ
Deforestación y desigualdad de la tierra: un análisis econométrico en el posconflicto
colombiano (2015-2019) 203
- WILMAN CARPETA CAMACHO
Big data analytics in programme evaluation: Examining models for the assessment of
sustainable development goals in Colombia 233
- LINA MERCEDES GUERRERO DURÁN, ALEJANDRO DAVID MARTÍNEZ AMARIZ,
ÉDGAR LUNA GONZÁLEZ Y DIEGO ORLANDO RODRÍGUEZ ORTIZ
Validación de la hipótesis de eficiencia de mercado en las acciones del COLCAP
mediante la aplicación de análisis técnico 265
- CARLOS ALBERTO SUESCÚN-BARÓN, CÉSAR AUGUSTO GIRALDO GIRALDO,
JUAN PABLO SANDOVAL CASTAÑO Y VIVIAN ANDREA CANTOR ÁVILA
La frontera agraria en disputa: análisis de algunos conflictos territoriales sobre
comunidades étnicas y campesinas en Colombia 297
- VÍCTOR MAURICIO CASTAÑEDA RODRÍGUEZ
El esfuerzo tributario de los municipios colombianos entre 2011 y 2017. ¿Hay espacio
para aumentar su recaudación? 331
- HERNÁN VALLEJO
Not all giffen goods, are inferior goods 359
- MANUEL RUBIO-GARCÍA
Elementos esenciales de una socioeconomía del desarrollo 379

